

For optimal performance of the Stinger VIP it is important to carefully follow the directions provided in this installation manual. For questions please call Stinger technical support at **1-844-RADARUS (723-2787)**. For more information, check www.stinger.com/us

Please first confer with the customer to determine the desired position for the VIP Display in the car. We advise to place the VIP Display Holder so that the display will be easily visible for - and within comfortable reach of - the driver.

SCHEMATIC VIEW

Module locations

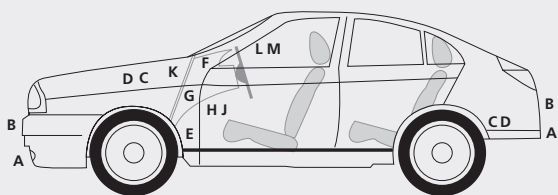

- A HD Antennas (Front&Rear)
- B Laser Receiver Square (F&R)
Laser Transmitter Square (F&R)
- C Extension Boxes (F&R)
- D Laser Analyzer Boxes (F&R)
- E Speaker
- F USB Cable
- G VIP Computer
- H I/O Plug
- J Power Plug
- K GPS Antenna
- L VIP Display Holder
- M VIP Display

In or behind the bumper / grill

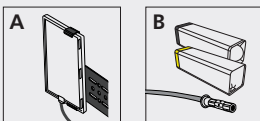

Under hood / in trunk

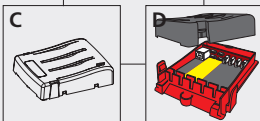

Under the dashboard

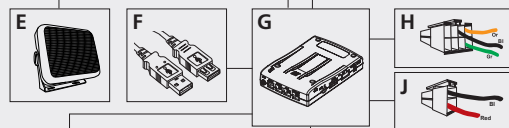

Sky view

In the cockpit

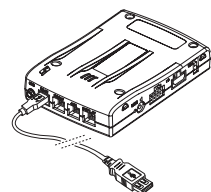
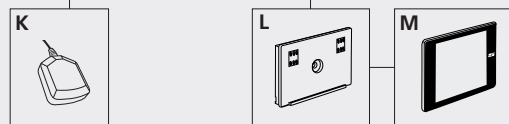

1. VIP Computer

The VIP Computer must be placed in a humidity-free location such as in or under the dashboard.

- Mount the VIP Computer with tie-wraps or screws.
- **note:** Connect one end of the USB Cable to the VIP Computer and make sure the other end remains easily accessible, for instance lying free in the glove box.



2. Extension Box

Place the Extension Box horizontally (as depicted) under the hood, in a reasonably humidity-free location.

- Connect the Extension Box for the **front** of the car to the **FRONT** port of the VIP Computer.
- Connect the Extension Box for the **rear** of the car to the **AUX** port of the VIP Computer.

Do not yet close the lid of the Extension Box.

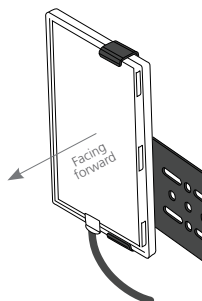

3. HD Antenna

Place the HD Antenna at the front of the car behind the bumper or spoiler. Preferably behind thin, flat and smooth plastic, **and certainly not behind metal.**

- The large, smooth side that has no imprints, must face straight forward in the driving direction, with the cable coming out from the bottom, as depicted.
- Connect it to any port of the Extension Box. The Antenna must never be connected to the Laser Analyzer Box: this can cause a short-circuit.
- For maximum performance, please make sure the antenna receives sufficient airflow for cooling.
- Please see reverse side of this sheet for US and Canadian HD Antenna optimized installation orientation.

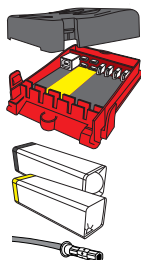

4. Lasers and Laser Analyzer Box

Connect the Laser Analyzer Box to the Extension Box and the Lasers to the Laser Analyzer Box.

To ensure optimal Laser functionality, please refer to the exact Laser installation instructions in the separate Laser Installation Manual. Download available at: www.stinger.com/manuals

STEP BY STEP INSTRUCTIONS

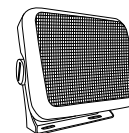

5. Speaker

Place the speaker under the dashboard.

- Connect the module to the Speaker port (🔊) of the VIP Computer.



6. GPS Antenna

Place the antenna on the dashboard. If the car has a heat-repelling windshield, it is better to place the antenna outside the cabin of the car, for instance in a space at the top end of the hood.

- Connect the cable of the antenna to the GPS port of the VIP Computer.

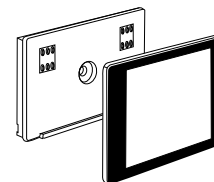

7. VIP Display & VIP Display Holder

Place the VIP Display Holder at a convenient location for the driver.

- Connect the module to the DISPLAY port of the VIP Computer.
- Place the VIP Display on the VIP Display Holder.



8. 8-pole I/O plug

- Connect the orange wire to the ignition-actuated 13.8V battery power (+15).
- If so desired, attach the green Mute-cable to the Mute-wire of the radio.
- The black wire is for future use.



9. 2-pole power plug

- Connect the red wire to the 13.8V battery power (+30).
- Connect the black wire to a 'clean' metal ground-point of the car chassis.

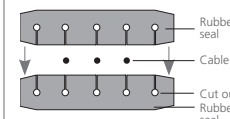

10. Closing the Extension Box and Laser Analyzer Box

After all the cables have been connected, it is important to close the boxes (see steps 2 and 5) in a water resistant manner. Place the cables in the holes of the opposite facing 'rubber seals' (see example). This prevents moisture from getting into the box.

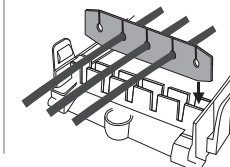

Next, place the rubber seals with the now inserted cables into the slot, as depicted in the example on the left. Make sure the rubbers are pushed down all the way using silicone spray to facilitate this. Put the lid back on so that it is tight and secure.

HD ANTENNA INSTALLATION POSITION

HD Antenna Installation for US RADARS

For optimal performance, the Stinger HD Antenna has been designed for Vertical (Portrait) orientation as seen in the diagram below.

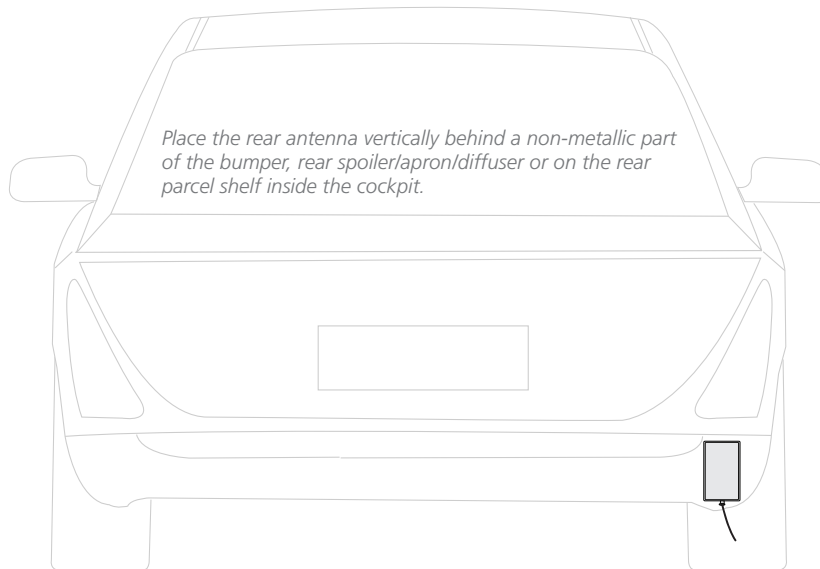
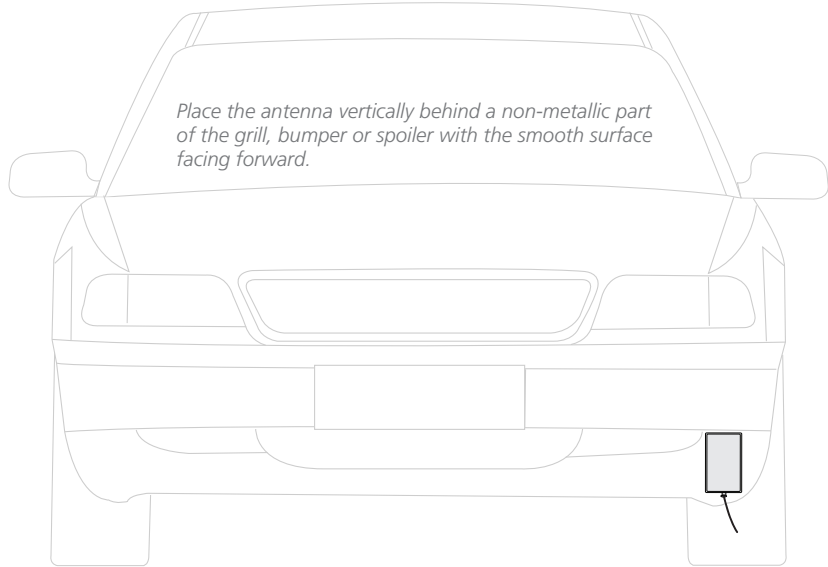

WIRING DIAGRAM

